

# HASP<sup>®</sup>LOCK

## ASSEMBLY INSTRUCTIONS

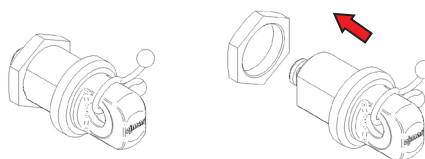

1.  
Remove the nut from the lock.



2.  
Introduce lock inside the  
footprint of the locker door (logo  
OJMAR in horizontal position).

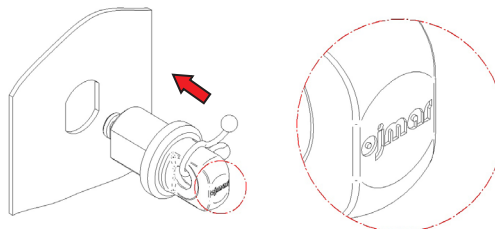

3.  
Fix lock with the nut.

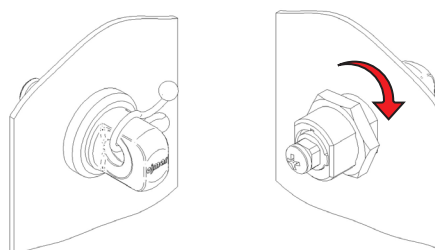

4.  
Remove the screw M5 and the  
washer for the cam.

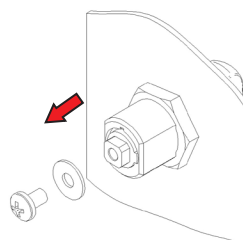

5.  
Assemble the cam to the lock and mount  
it with the washer and the screw. Torque  
recommended 10-12 dN.m.

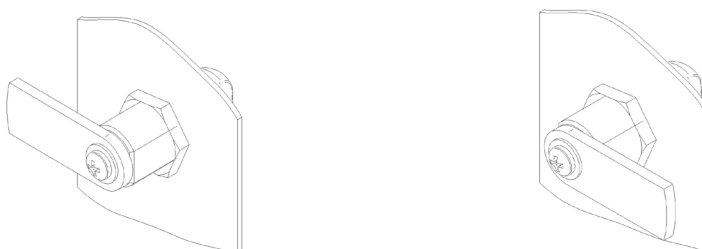

6.  
Release the plastic part.

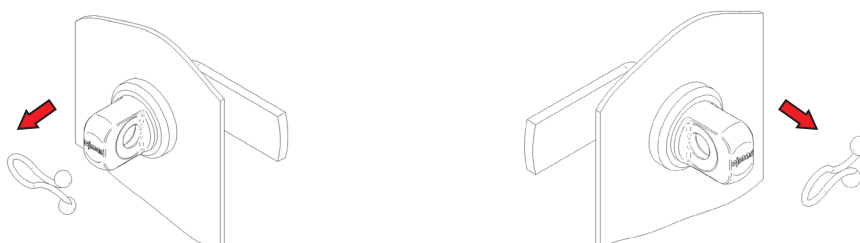



INTELLIGENT LOCKING SYSTEMS

CONTACT  
sales@ojmar.com  
+34.943.748.484

OJMAR HQ  
Polígono Industrial de Lerun  
20870 Elgoibar - SPAIN

OJMAR USA  
17155 Von Karman Ave, S111  
Irvine CA. 92614 - USA

[www.ojmar.com](http://www.ojmar.com)