

# SIMPLE KEYLESS ACCESS

The KL1000 is a compact digital lock ideal for replacing keyed cam locks commonly supplied on a wide range of lockers, cabinets and cupboards.

This neat lock is easy to fit, taking just a few minutes to remove the existing cam lock and making an additional top fixing. KL1000 can also be fitted to a locker or cabinet that does not have an existing locking device – just drill another hole. Once in place the lock will perform up to 15,000 openings on just two AAA batteries. Access control without the need for keys.

## FEATURES

- 11 button keypad
- 8 digit Master and Sub-Master Code
- 4 digit User Code
- 6 digit Technician Code
- Three options available
- Private / Public Function
- Easy to fit and program
- 15,000 operations from 2 x AAA batteries
- Battery Override
- Vertical / right hand / left hand versions
- IP55 rated when fitted with gasket
- All parts / fixings / templates included
- Two year guarantee\*

# KL1000





KL1000 vertical



KL1000 right hand



KL1000 left hand



**KL1000 has two functions:**

**Private Function**

This is the default function and is already pre-programmed in new locks. This function is used where the same code will be repeatedly used, e.g. a pupil in a school or an employee with the same locker in the workplace.

**Public Function**

In this function the KitLock operates with a single User Code. The user enters a personal four-digit code. This locks the lock. The same code is entered once only to open the lock before automatically being erased and ready for the next user. This function is used for short-term, multiple occupancy applications, e.g. a locker in a sports club.



**KL1000 has four code levels available:**

8 digit Master Code / 8 digit Sub-Master Code  
4 digit User Code / 6 digit Technician Code

**The KitLock is supplied with two factory set codes:**

Master Code  
User Code

Before fitting change the Master and User Code.

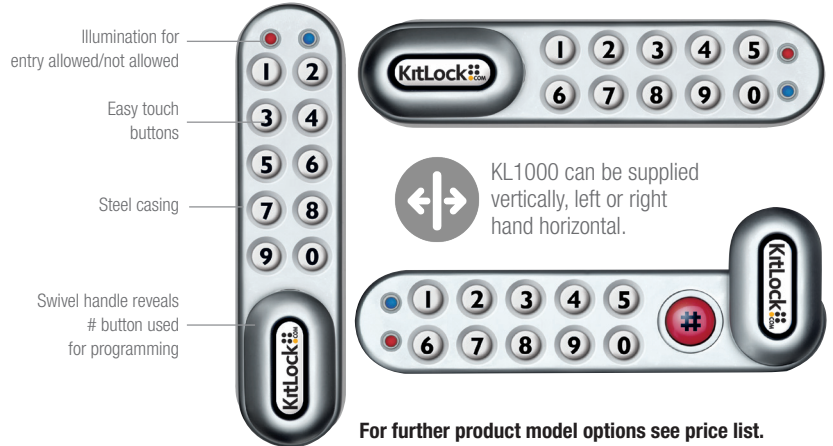

For further product model options see price list.

EASY INSTALLATION

- 1 KitLock
- 2 Upper fixing bolt x 2
- 3 Cam spindles x 3
- 4 Packer pieces x 3
- 5 Locking nut
- 6 Cams x 2
- 7 Cam fixing bolt

Batteries – 2 x 1.5V AAA  
Template x 1

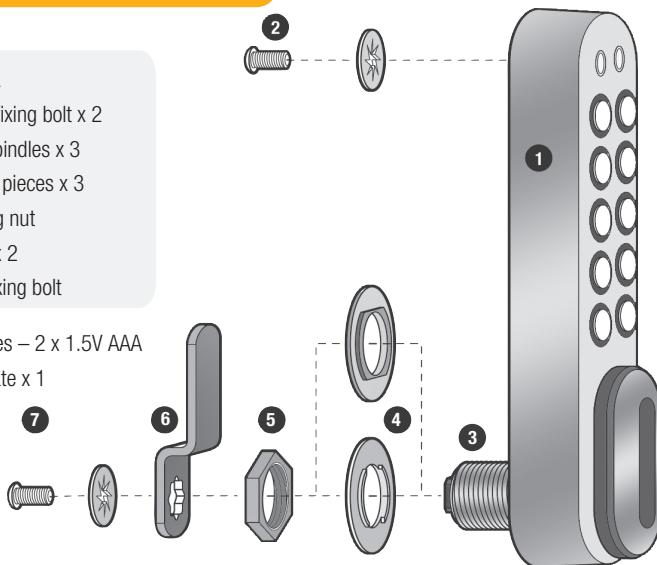

TECHNICAL SPECIFICATIONS

Options	Three available
Operations	15,000 openings
Batteries	2 x 1.5 AAA cells (supplied)
Low Battery Warning	Red LED will flash on opening to indicate batteries need to be changed
Memory	Non-volatile memory will be retained
Battery Override	A 9 volt battery can be placed against external contacts
Material	Zinc Alloy
Functions	Private and Public
Door Thickness	Ready to fit doors up to 25mm (1")
Buttons	11 individual round buttons
Fitting	Easy to fit and program
Fitting Options	Vertical, right and left hand models
Finish	Silver grey and black as standard (colour options available)
External Dimensions (to top of handle)	136mmL x 33mmW x 28mmD (5 <sup>3</sup> / <sub>8</sub> " x 1 <sup>5</sup> / <sub>16</sub> " x 1 <sup>1</sup> / <sub>8</sub> " )
IP55 Rated	When used with rubber gasket (available separately)

\*Codelocks and KitLocks electronic locks offer a two year guarantee and will be repaired, serviced or replaced free of charge if they develop a manufacturing fault. Faults caused by misuse, abuse and/or poor fitting are not covered by the guarantees.

